

## SEEMEE 508 USER MANUAL

### PRODUCT DESCRIPTION

As a device that can monitor approaching vehicles behind within a certain range, the SEEMEE 508 Radar Tail Light contains a micro radar and a multi-mode controllable tail light. It can be used together with the display terminal to help improve your perception of the surroundings during riding.

This device can enhance the detection of the environment but is not a substitute for the rider's attention and judgment. Please always pay attention to the road conditions and take a safe ride.

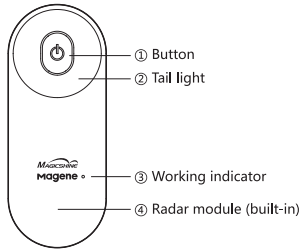

① Button	Power-on/power-off, switch working mode	Press and hold for 2s to power on
② Tail light	Rear warning light, with multiple flashing modes	Click the button to switch the mode: Solid mode → Flash mode → Pulse mode → Peloton mode → Single Radar mode, cyclic switching
③ Working indicator	Working indicator, based on indicators such as power status, charging status, working mode, etc	
④ Radar module (built-in)	Radar transmitter module, used to monitor moving objects behind	

### WORKING INDICATOR

Working indicator	Description
The indicator flashes quickly	Low battery
The indicator flashes slowly	Charging, it goes out after being fully charged
The indicator flickers	Firmware update in process
The indicator goes out in the working status	Radar function off
The indicator is always on	Radar failure

### TAIL LIGHT MODE

Mode	Indicator luminance	Default flash setting	Runtime
Solid mode	On	None	6H
Flash mode	On	Slow	10H
Pulse mode	On	Slow	12H
Peloton mode	Soft	None	8H
Rotation mode	On	Rotating	10H
Single Radar mode	None	None	16H
Brake	Highlight	On for 3 seconds	/

### DEVICE INSTALLATION TIPS

#### List of devices

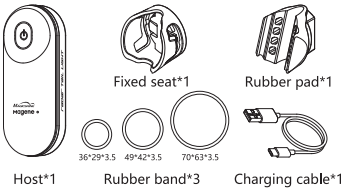

### INSTALLATION PRECAUTIONS

- Select a suitable position to install the device to ensure that it will not affect your riding safety.
- Install the device at the appropriate height of the seat rod to acquire the optimal detection range.
- The fixed seat shall be installed vertically, and the matched installing seat can adapt to most seat rod types and angles.
- Correct installation, with the device facing back and perpendicular to the road surface.
- Make sure there is no obstruction in front of the device.

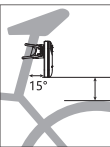

### INSTALL THE UNIVERSAL FIXED SEAT

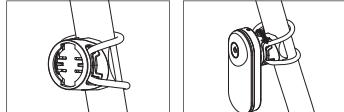
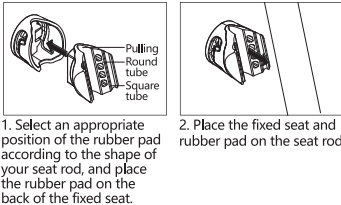

3. Fix it with a rubber band.

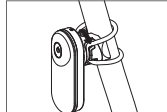

4. Align the card tray on the back of the device with the clasp of the fixed seat and turn it clockwise until the device is locked.

Note: In order to prevent the device from being lost due to the aging and fracture of a rubber band, the suspending rope that the product is equipped with can be installed together.

### MATCHED WITH BIKE COMPUTER

This device can be matched with other display devices that support the standard ANT+ protocol of radar. You can judge the situation of vehicles coming from behind through the information prompted on the display device for the purpose of a safe ride. Matching operations are as follows:

1. Keep the display device 3 meters away from this device and turn both on.
2. Select "Add sensors" ("Search sensors") on the sensor page of the display device or the corresponding APP interface.
3. Select this device in the search results to connect.

### Warnings:

- If the radar device does not send radar detection information to the display equipment, you are recommended to stop riding and check the equipment at a safe position to ensure your safety, you can turn off these two devices, restart them, and then try to connect again.
- The interface of the display device is for illustration only, and the specific display form shall be subject to the marks on the display device.



### APP SETTINGS AND UPDATES

SEEMEE 508 can be connected to Magene Utility with Bluetooth. You can upgrade the firmware of the device, set the mode preference, etc. in the APP.



### PRODUCT SPECIFICATIONS

Model	SEEMEE 508
Battery type	Built-in rechargeable Lithium battery/1500mAh
Application temperature range	-10°C-50°C (14°F-122°F)
Charging temperature range	0°C-45°C (32°F-113°F)
Suitable voltage	DC 5V, 750mA
Communication protocol	ANT+, Bluetooth
Transmission frequency	24.050GHz-24.250GHz (Radar) 2.402GHz-2.480GHz (Bluetooth)
Transmission power consumption (maximum transmission power)	10mW (Radar) 2.5mW (Bluetooth)
Waterproof rating	IPX7
Luminous flux	20lm (Solid mode, Flash mode) 3-20lm (Pulse mode) 6lm (Peloton mode)

Note: Product parameters for laboratory test results, the actual use of environmental factors interference, the actual results prevail.

### DEVICE CHARGING

**Notes:**  
Please keep the USB interface dry before charging to prevent metal corrosion.  
Tighten the USB cover after charging to prevent water ingress or interface damage.

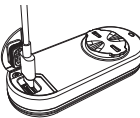

### MAINTENANCE AND CLEANING OF THE DEVICE

**Notes:**

- Do not store the device in an environment with an extreme temperature for a long time because it may cause permanent damage.
- Avoid using organic solvents, chemicals, or repellents, because it may cause damage to parts of the device.
- Try to avoid violent impact or rough use because it may shorten the life of the product.
- Do not use any cloth or other materials that may scratch the optical lenses. Scratches may give rise to a decline in the performance of radar detection.
- Regular cleaning of mud or dirt on the device can prolong its service life.

### RADAR DETECTION

This device can enhance the inspection of the environment but is not a substitute for the rider's attention and judgment. Please always pay attention to the road conditions and take a safe ride. Failure to follow relevant instructions may result in death or severe injury.

- Radar can detect approaching vehicles within a distance of about 140 meters.
- The relative speed of approaching vehicles that can be detected by radar must be within 10km/h - 120km/h (6 - 75mph).
  - Note: radar will not detect vehicles traveling at the same speed as you or away from you.
- The radar beam width is 40°-20°-20°.
- Radar can detect eight approaching vehicles at most.

### FAQS

Question	Solutions
No response after power-on/incapable of power-on	Please ensure that the device is within the permissible range of operating temperature; Please check the power and try to charge the device to ensure that it is fully charged up before use;
Indoor power-on and alarm of radar detection	The device can detect vehicles in an outdoor environment. If it is started indoors, a saturation alarm may occur, therefore, please use it outdoors;
The device cannot be charged	Please check the USB charging cable, connector or port for damage; Please ensure that the device is within the permissible range of charging temperature;
The O-shaped rubber ring is damaged	The product is equipped with an O-shaped rubber ring, please keep it properly on standby. The O-ring is a consumable product, therefore, please buy it yourself if it is lost or damaged;
Unable to connect to APP or Bike Computer	Please ensure that the device is within the permissible range of operating temperature; Please try to connect again after restarting the device; Avoid multiple sources of radar interference;
The radar tail light does not work during charging	The device is off by default during charging;

### SAFETY WARNINGS AND PRODUCT NOTICE

#### Warnings

Failure to notice the potential dangers listed below may lead to severe harm or even fatal accidents.

#### Distraction warnings

- The device can improve your riding experience if used properly; you may be distracted by the screen and suffer from severe injury or death if the device is used improperly.
- Just check the information quickly and keep your attention on the surroundings at all times. Do not keep staring at the display or be distracted by it.
- Paying excessive attention to the screen display may lead to your neglect of obstacles or dangers. You will take risks for all the serious consequences arising therefrom, therefore, please use this device in an appropriate and careful manner.

#### Battery-related warnings

- The product has a rechargeable lithium battery.
- Failure to follow the instructions listed below may shorten the battery's shelf life, damage the device, or cause fire, chemical burns, electrolyte leakage, or the risk of injury.
- Do not disassemble, modify, puncture, or damage the device or the battery violently.
- Do not expose the device or the battery to fire, explosion, or other hazards.
- Do not place or store the device near a dryer, in a car under direct sunlight, or in other high-temperature environments.
- Do not immerse the battery in water or other liquids.

#### Riding warnings

- Be sure to keep your best sense of attention and judgment and ride in the safest way.
- Please make sure that your bike and all components are well maintained and all parts are installed correctly.

#### FCC STATEMENTS

This device complies with part 15 of the FCC rules. Operation is subject to the following two conditions: (1) this device may not cause harmful interference, and (2) this device must accept any interference received, including interference that may cause undesired operation. NOTE: The manufacturer is not responsible for any radio or TV interference caused by unauthorized modifications or changes to this equipment. Such modifications or changes could void the user's authority to operate the equipment.

**NOTE:** This equipment has been tested and found to comply with the limits for a Class B digital device, pursuant to part 15 of the FCC Rules. These limits are designed to provide reasonable protection against harmful interference in a residential installation. This equipment generates uses and can radiate radio frequency energy and, if not installed and used in accordance with the instructions, may cause harmful interference to radio communications. However, there is no guarantee that interference will not occur in a particular installation. If this equipment does cause harmful interference to radio or television reception, which can be determined by turning the equipment off and on, the user is encouraged to try to correct the interference by one or more of the following measures:

- Reorient or relocate the receiving antenna.
- Increase the separation between the equipment and receiver.
- Connect the equipment into an outlet on a circuit different from that to which the receiver is connected.
- Consult the dealer or an experienced radio/TV technician for help.

The device has been evaluated to meet general RF exposure requirement. The device can be used in portable exposure condition without restriction. Federal Communication Commission (FCC) Radiation Exposure Statement Power is so low that no RF exposure calculation is needed.

#### CE DECLARATION OF CONFORMITY

Hereby, MAGICSHINE & MAGENE declares that this product is in compliance with the Directive 2014/53/EU. The full text of the EU declaration of conformity is available at the following internet address: <https://magenefitness.com/certificate.html>

#### UK DECLARATION OF CONFORMITY

Hereby, MAGICSHINE & MAGENE declares that this product is in compliance with The Radio Equipment Regulations 2017. The full text of the declaration of conformity is available at the following internet address: <https://magenefitness.com/certificate.html>

### WARRANTY TERMS

Thank you for purchasing the product of MAGICSHINE. Please read the following terms carefully.

#### Repair, Replacement, and Return:

- This product has been strictly tested for quality. According to this Warranty, during the warranty period, if this product suffers from quality-related failures when being properly used, free warranty service will be provided.
- The user can return or replace the product without any reason within 7 days as from the day of purchase (included) if the product suffers from any quality issues.
- The warranty period of the product host is 12 months from the purchase date, and that of other accessories is three months, subject to the warranty period on the [Electronic Warranty Card].
- For repairs covered by the Warranty, the product must be packed in the original package and transported by the specified carrier. Otherwise, the user shall bear the freight or any loss caused by the transportation.

#### The following situations are not covered by the warranty:

- The warranty period has expired.
- Any damage caused by improper use, maintenance, or storage.
- The product is damaged because the user did not use or install the product as instructed in the user manual.
- The failure is caused by unauthorized repair, misuse, collision, negligence, abuse, liquid ingress, accident,

SEEMEE 508 Radar Tail Light	
Model	SEEMEE 508
Nominal Voltage	3.7V
Nominal Capacity	1500mAh
RefWeight	65g
Manufacturer	MAGENE
Address	No.2 AWS, Road, Licang District, Qingdao Shandong China
	WSJ Product LTD(for authorities only)
	Eschborner Landstraße 42-50
	60489 Frankfurt am Main, Hessen, Germany
EC REP	UK Authorised Representative: WSJ Product LTD.
	Unit 1 Alsop Arcade, brownlow hill, Liverpool, L3 5TX, GB